

CXL/CXLT FRONT ASSEMBLY

PRODUCT INFORMATION



POLYJOHN[®]
there when you need us



NOTE: We recommend reading through the entire Assembly Instructions prior to proceeding with installation, service or maintenance. All references to left and right throughout this guide are as viewed from the front.

PARTS DIAGRAM

PH03-0003 FRONT ASSEMBLY

CXL/CXLT FRONT ASSEMBLY
PH03-0003RL

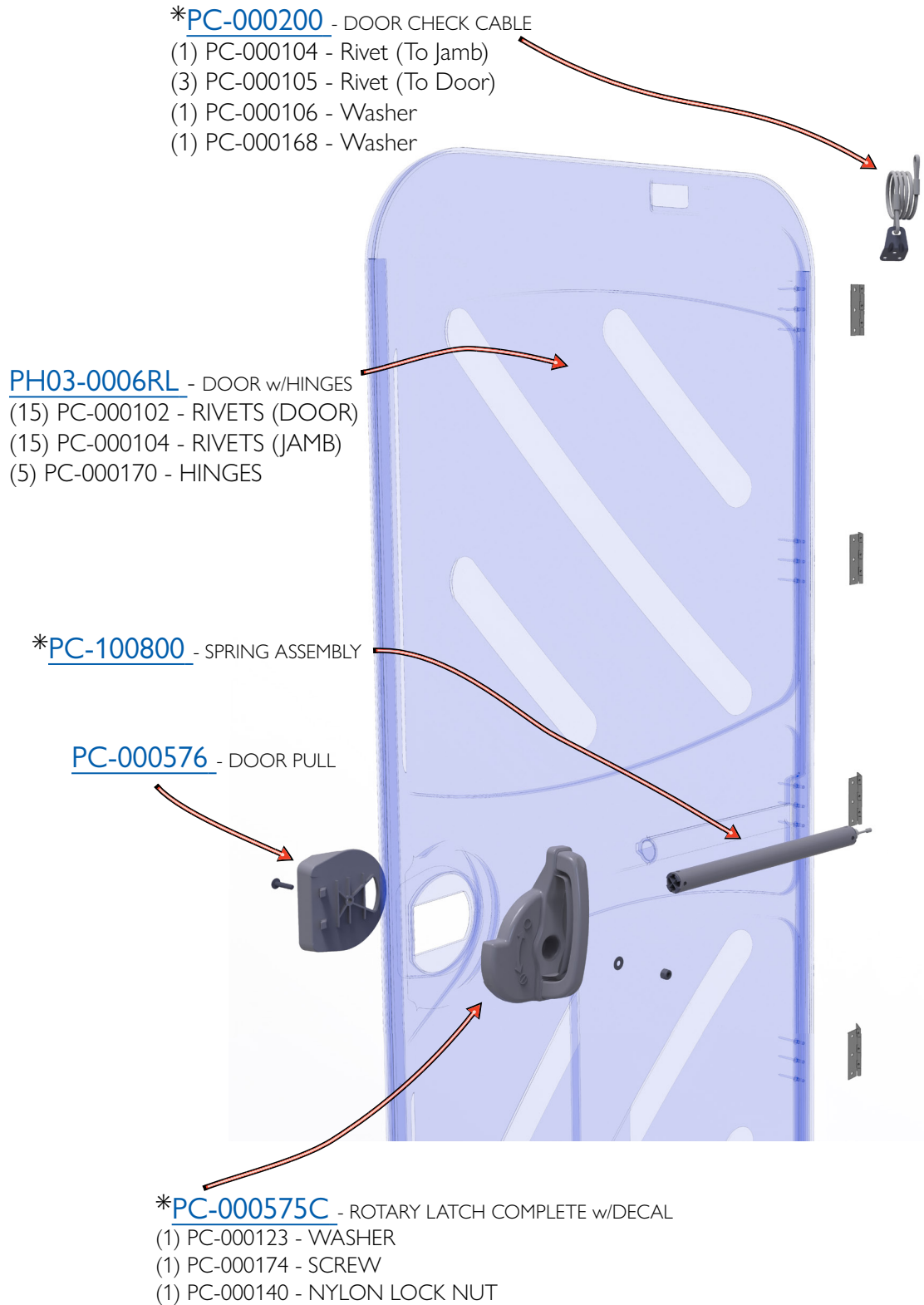

CXL/CXLT FRONT ASSEMBLY
PH03-0003RL

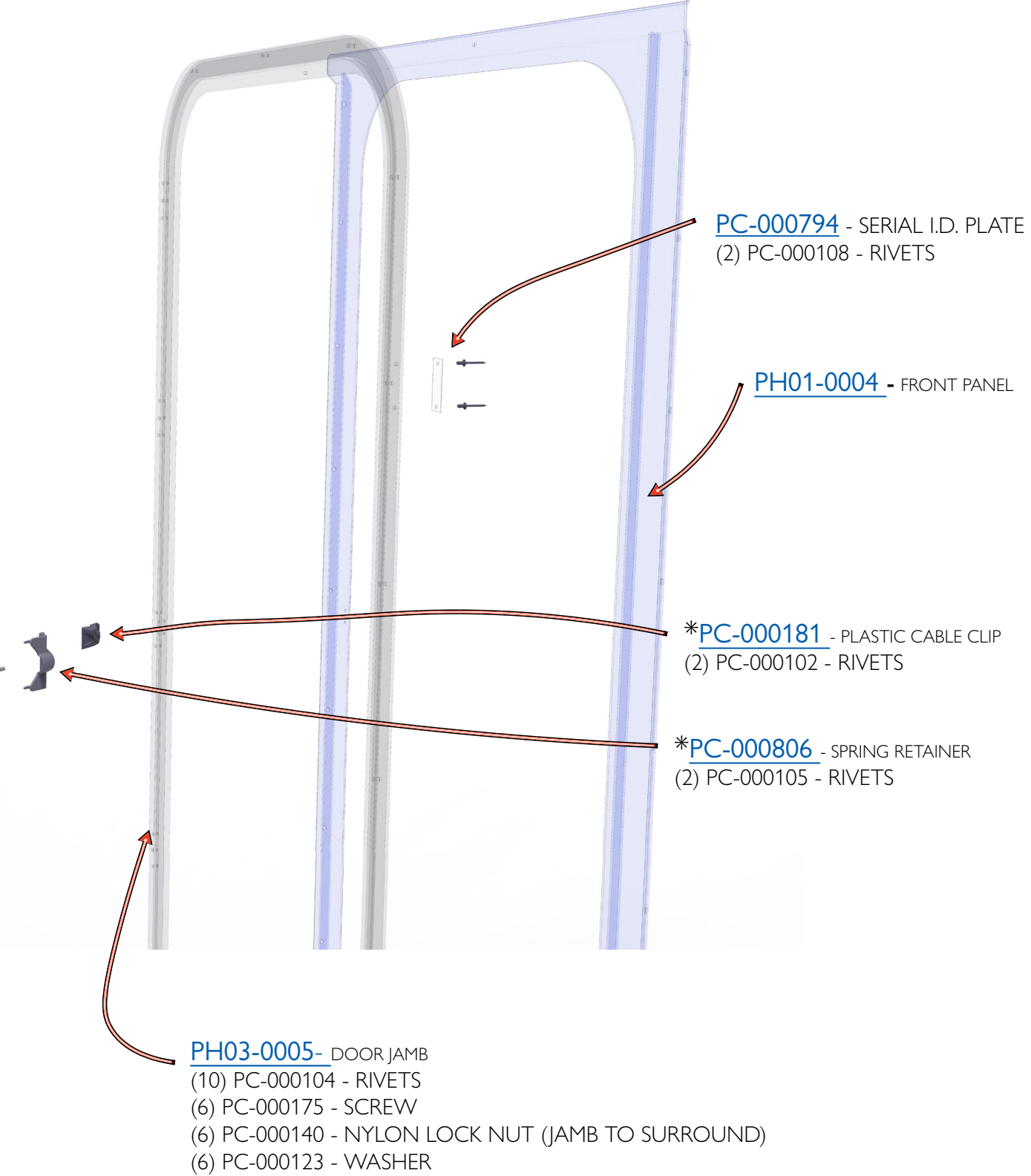

ASSEMBLY INSTRUCTIONS

CXL/CXLT FRONT ASSEMBLY
PH03-0003RL

ROTARY LATCH

Place the door handle PC-000576 such that the edge of the opening in the door catches the hinge points on the handle. When the handle is in place, insert the screw PC-000174 through the handle's center mounting hole. Take the rotary latch, PC-000575C, and place it in the door opening from the backside of the door. Guide it on to the screw. Use washer PC-000123 and nut PC-000140 to fasten the two halves together. Adjust the tightness of the screw to adjust the ease of the latch movement.

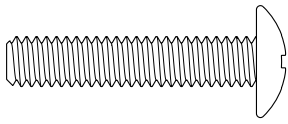
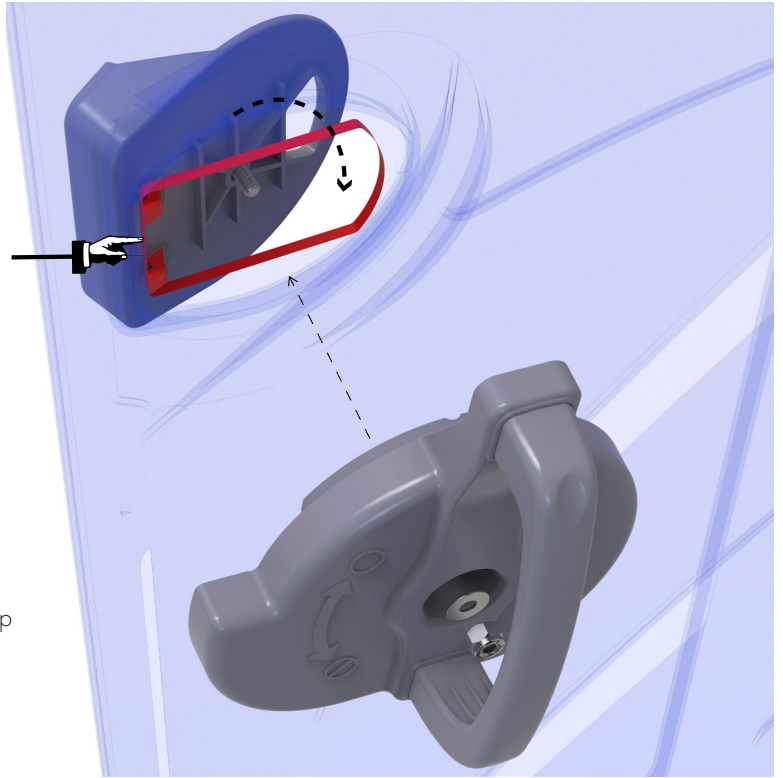

PC-000174 Bolt
1 Used in this step

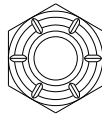

PC-000140
1 Used in this step

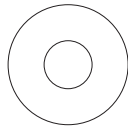

PC-000123 Washer
1 Used in this step

DOOR CHECK CABLE

Align the three holes of the metal bracket on the door check cable to the holes in the top inside center of the door so that the bracket angles toward the unit and the three holes line up with the holes in the bracket (as shown). Rivet into place using (3) PC-000105 rivets. From the outside of the unit, insert a PC-000104 rivet into the pre-drilled hole at the top of the door opening of the door jamb. Place the looped end of the door check cable on the end of the rivet followed by (1) PC-000168 washer and (1) PC-000106 back-up washer. Rivet in place.

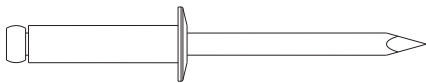

PC-000104 Rivet
1 Used in this step

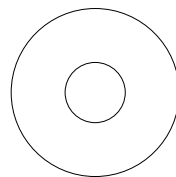

PC-000168 Washer
1 Used in this step

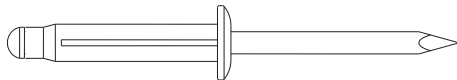

PC-000105 Rivet
3 Used in this step



PC-000106 Washer
1 Used in this step

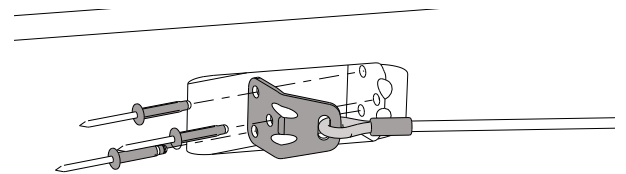

ASSEMBLY INSTRUCTIONS

CXL/CXLT FRONT ASSEMBLY

PH03-0003RL

DOOR CLOSURE INSTALLATION

Push the spring tube assembly into the hole in the center molded pocket of the door with the cable end towards the hinged side of the door. Insert the tabs of the door closure retainer clip into the 2 pre-drilled holes as shown below. Pivot the retainer clip into place while feeding the spring cable through the hole in the retainer clip. Rivet into place with (2) PC-000105 rivets. Line up the cable clip in the center of the door jamb to the door closure retainer clip. From inside the unit using a 13/64" bit, drill two holes into one side of the door jamb only. Rivet the cable clip to the door jamb using (2) PC-000102 rivets. On the inside of the unit, place the top of a hammer against the cable clip. Place the barrel end of the spring cable in the claw of the hammer. Open the door while holding the hammer in position. Hold the door open with your foot and clamp a vice-grip pliers on the cable where it comes out of the door. **BE SURE TO CLAMP DOWN TIGHT.** Remove the cable from the claw of the hammer, close the door and place the end of the cable into the slot of the cable clip. Open the door and remove the vice-grips.

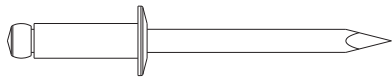

PC-000102 Rivet
2 Used in this step

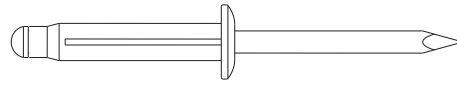

PC-000105 Rivet
2 Used in this step

